

One-, Double- and Triple-Hole Detector Type PP2451q/308/R153 for Detection of Welded Seams

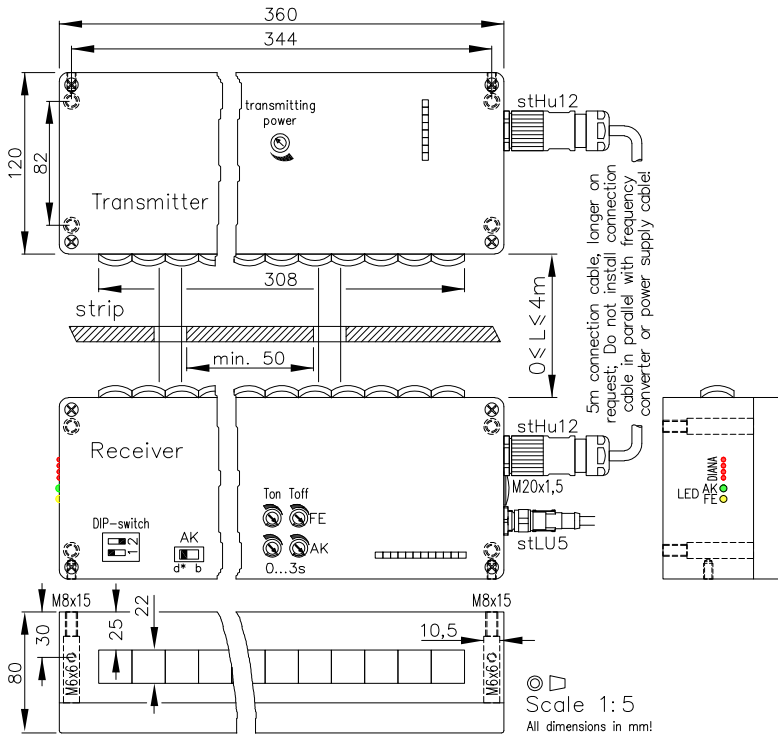

Connection diagram transmitter:

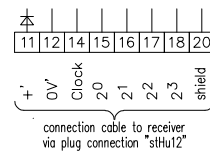

Connection diagram receiver:

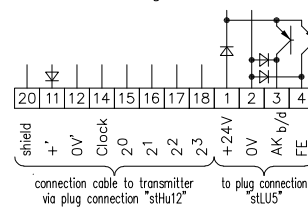

Connection diagram "stLU5":

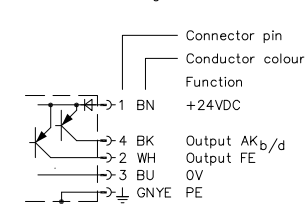
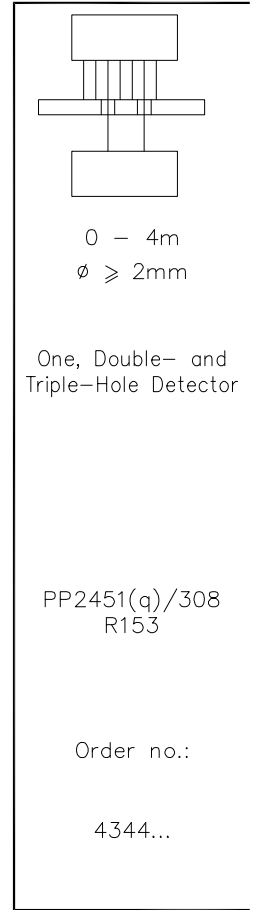
0 - 4m
 $\phi \geq 2\text{mm}$

One, Double- and Triple-Hole Detector

PP2451(q)/308
 R153

Order no.:
 4344...

Technical Characteristics:

Housing	Al-Cast
Weight	approx. 5000g
Protection Mode	IP65
Supply	24VDC/~700mA without load
Output	pnp 60mA s.c.prot.,e2
Signal Mode	Bright-/darkswitching, selectable (only AK)
Transmitter Light	GaAs 850...880nm
Steady Light Resistance	>80kLx
Operational mode	multiplex
Interference Suppression	Forced Synchronisation
Access Time	<2ms/Switch Transition
Switching Frequency	~300/s
Switch Indicator	LEDs green (AK), yellow (FE)
Level Indicator	4x LED red (DIANA, i)
Time Delay	0...3s switch-on-off-delay, z3
Ambient Temperature	-25...+60°C

Selection of detection mode:

Detection mode	A	B*	C
No. of holes to detect	only 1	only 2	only 3
Output signal "AK"	1	2	3
No. of holes detected	more than 1	more than 2	more than 3
Output signal "FE"	more than 1	more than 2	more than 3
Position of DIP-switches			

*: factory setting

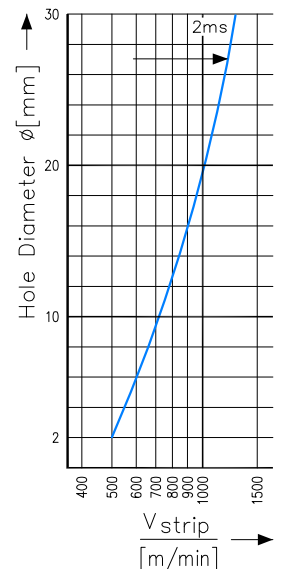

4344 DE (21.01.13 tb)
 4344 E (02.03.16 tb)
 4344 F (01.08.12 tb)
 4344 G (11.12.12 tb)

Special Design:

Heat-protected optical system, pl
 If using cooling water flange, then milled wall, y
 Supply* 42...48VAC, 115VAC, 230VAC
 Output* npn, e3; Optocoupler, e1
 Relay, 5A, 900VA, 1xCh, R
 *: with control unit PP85302

Accessories:

Control Unit PP85302, (#2437)
 Cooling Water Flange KW153

The design and make of the devices and their electronics are intellectual property of the company "Fotoelektrik Pauly GmbH". Internal circuit diagrams can, for copyright reasons, not be given therefore. Subject to technical alterations. Errors excepted. The reprinting of this data sheet or the copying of extracts from it are allowed only with the approval of the "Fotoelektrik Pauly GmbH" and with an indication of the sources used. Infringements are punishable by law.